

## ГРАНИТОР HURAKAN HKN-MT2

| Поз | Наименование детали          |
|-----|------------------------------|
| 1   | Lid                          |
| 2   | Inner Lid                    |
| 3   | Tank                         |
| 4   | Spring                       |
| 5   | Plunger                      |
| 6   | Small O-ring                 |
| 7   | Handle                       |
| 8   | Handle Pin                   |
| 9   | Bowl O-ring                  |
| 10  | Outer Auger                  |
| 11  | Shaft Washer                 |
| 12  | Shaft Seal                   |
| 13  | Auger Seal                   |
| 14  | Outer Auger Adapter          |
| 15  | Plug                         |
| 16  | Left panel                   |
| 17  | Condenser                    |
| 18  | Front wall                   |
| 19  | Drip tray grill              |
| 20  | Drip tray                    |
| 21  | Evaporator                   |
| 22  | Auger shaft                  |
| 23  | Copper bushing               |
| 24  | Limit switch                 |
| 25  | Mixer motor                  |
| 26  | Spring                       |
| 27  | Shaft                        |
| 28  | Rear motor frame             |
| 29  | Fixed panel                  |
| 30  | Rear wall                    |
| 31  | Solenoid valve block         |
| 32  | Leg                          |
| 33  | Compressor                   |
| 34  | Compressor regenerator       |
| 35  | Fuse                         |
| 36  | Motor fan                    |
| 37  | Fan                          |
| 38  | Stir buttons                 |
| 39  | Power button                 |
| 40  | Cooling button               |
| 41  | Side panel handle            |
| 42  | Single-sided cooling buttons |
| 43  | Right panel                  |

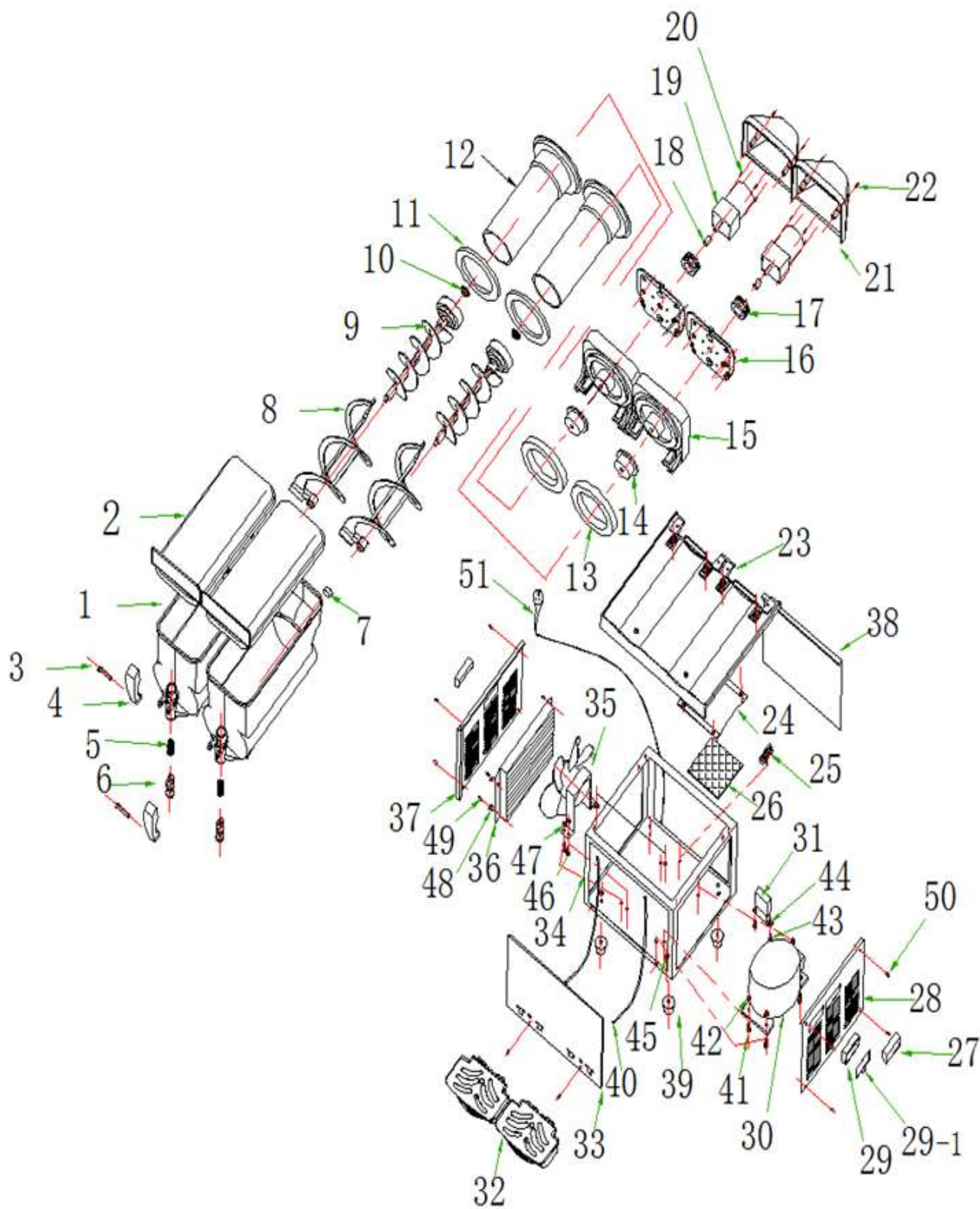

**ГРАНИТОР HURAKAN HKN-MT2 OLD**

| Поз  | Наименование детали              | Кол |
|------|----------------------------------|-----|
| 1    | Tank                             | 2   |
| 2    | Roof                             | 2   |
| 3    | Pin of handle                    | 2   |
| 4    | Handle                           | 2   |
| 5    | Spring                           | 2   |
| 6    | Plunger                          | 2   |
| 7    | Front plug                       | 2   |
| 8    | Outside stirrer                  | 2   |
| 9    | Inside stirrer                   | 2   |
| 10   | Back plug                        | 2   |
| 11   | Tank seal ring                   | 2   |
| 12   | Evaporator                       | 2   |
| 13   | Evaporator seal ring             | 2   |
| 14   | SS cover for stirrer             | 2   |
| 15   | Mix motor fixed parts            | 2   |
| 16   | Mix motor base                   | 2   |
| 17   | Magnets                          | 2   |
| 18   | Copper shaft                     | 2   |
| 19   | Mix motor                        | 2   |
| 20   | Mix motor fixed screw            | 8   |
| 21   | Mix motor cover                  | 2   |
| 22   | Mix motor screw                  | 4   |
| 23   | Base panel for 2 tanks           | 2   |
| 24   | PCB fixed panel                  | 1   |
| 25   | Solenoid valve assembly          | 1   |
| 26   | PCB board                        | 1   |
| 27   | Side panel handle                | 2   |
| 28   | Right side panel                 | 1   |
| 29   | Switch box assembly              | 1   |
| 29-1 | Transparent cover for switch box | 1   |
| 30   | Compressor                       | 1   |
| 31   | Regenerator of compressor        | 1   |
| 32   | Water tray                       | 2   |
| 33   | Front panel                      | 1   |
| 34   | Main shelf                       | 1   |
| 35   | Fan                              | 1   |
| 36   | Condensor                        | 1   |
| 37   | Left side panel                  | 1   |
| 38   | Back panel                       | 1   |
| 39   | Foot                             | 4   |
| 40   | Pipe                             | 2   |
| 41   | Compressor screw                 | 4   |
| 42   | Nut                              | 4   |
| 43   | Regenerator screw                | 2   |
| 44   | Nut                              | 2   |
| 45   | Foot nut                         | 4   |
| 46   | Fan screw                        | 4   |
| 47   | Nut                              | 4   |
| 48   | Insulation Mat                   | 4   |
| 49   | Rivet                            | 4   |
| 50   | Panel screw                      | 10  |
| 51   | Power line                       | 1   |